

# BARRENA WIRE - LINE Viejo Estilo NQ

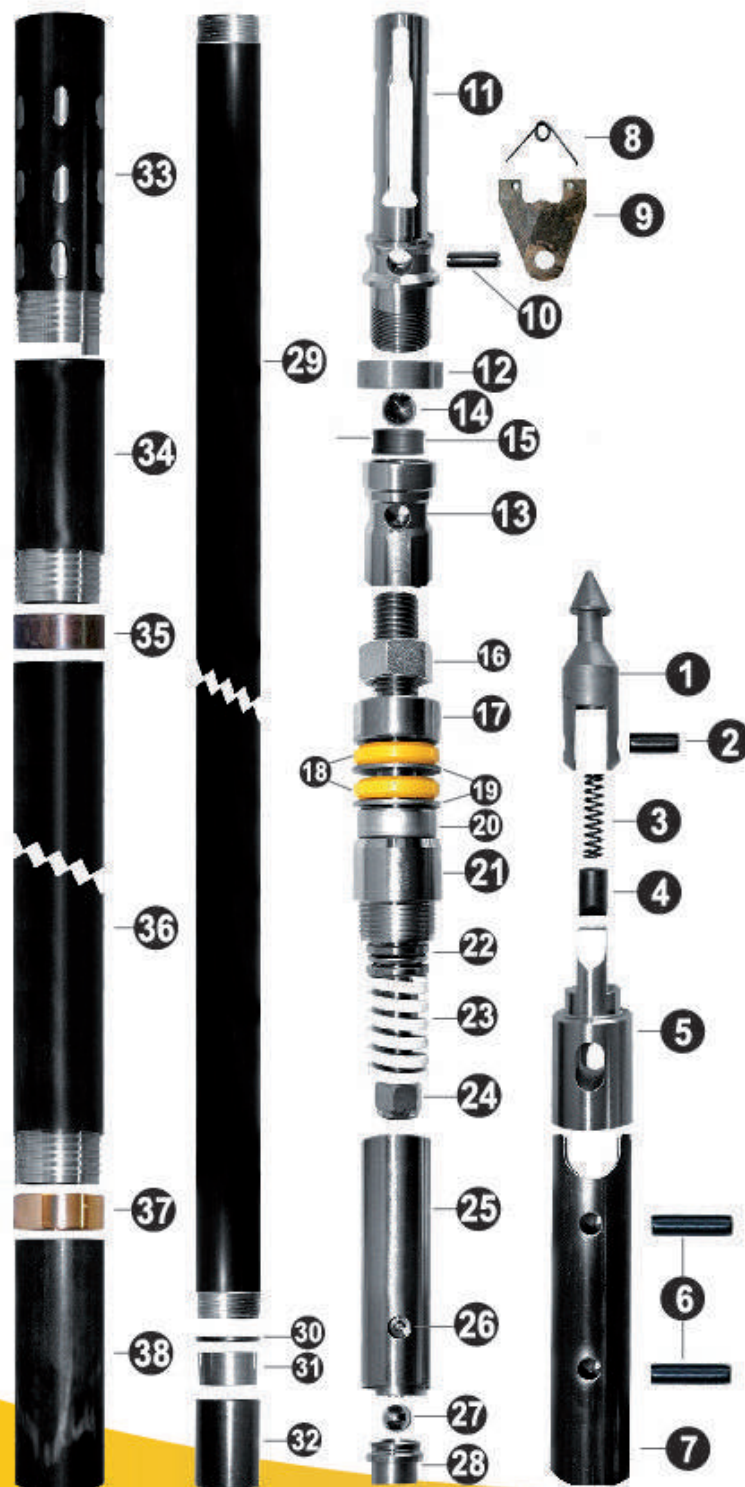

## Español

|    |  |
|----|--|
| 1  | PUNTA DE LANZA                         |
| 2  | PASADOR EN ESPIRAL 7/16" x 1"          |
| 3  | RESORTE PUNTA DE LANZA                 |
| 4  | DETEN PLUNGER                          |
| 5  | BASE PUNTA DE LANZA                    |
| 6  | PASADOR ENRESORTADO 1/2" x 2" - (2)    |
| 7  | CAMISA DE RETRACCION                   |
| 8  | RESORTE ALETAS                         |
| 9  | ALETAS - (2)                           |
| 10 | PASADOR ENRESORTADO 1/2" x 1-1/2"      |
| 11 | BASE ALETAS                            |
| 12 | ANILLO CABEZOTE                        |
| 13 | BASE ANILLO CABEZOTE                   |
| 14 | ESFERA 22.0mm                          |
| 15 | BUJE DE ASIENTO DE ESFERA              |
| 16 | TUERCA DE BLOQUEO                      |
| 17 | EJE PRINCIPAL DE BARRERA               |
| 18 | VALVULA DE CIERRE - (2)                |
| 19 | ARANDELA DE VALVULA (2)                |
| 20 | BALINERA EJE DE BARRERA GRANDE CERRADA |
| 21 | BUJE DE HUSILLO                        |
| 22 | BALINERA SUSPENSION PEQUENA ABIERTA    |
| 23 | RESORTE DE COMPRESION                  |
| 24 | TUERCA DE SEGURIDAD                    |
| 25 | TAPA TUBO INTERNO                      |
| 26 | GRASERA                                |
| 27 | ESFERA 22.0 mm                         |
| 28 | VALVULA BLOQUEO                        |
| 29 | TUBO INTERNO 5 PIES / 10 PIES          |
| 30 | ANILLO RETEN                           |
| 31 | RETENEDOR                              |
| 32 | PORTARETENEDOR                         |
| 33 | ACOPLE DE FIJACION                     |
| 34 | ACOPLE DE ADAPTACION                   |
| 35 | ANILLO DE ATERRIZAJE                   |
| 36 | TUBO EXTERNO 5 PIES / 10 PIES          |
| 37 | ANILLO ESTABILIZADOR                   |
| 38 | ACOPLE PROTECTOR                       |

## Inglés

|    |                              |
|----|------------------------------|
| 1  | SPEARHEAD POINT              |
| 2  | SPIRAL PIN (7/16" x 1")      |
| 3  | COMPRESSION SPRING           |
| 4  | DETEN PLUNGER                |
| 5  | SPEARHEAD BASE               |
| 6  | SPRING PIN (1/2" x 2") - (2) |
| 7  | LATCH RETRACTING CASE        |
| 8  | LATCH SPRING                 |
| 9  | LATCH (2)                    |
| 10 | SPRING PIN (1/2" x 1-1/2")   |
| 11 | UPPER BODY                   |
| 12 | LANDING SHOULDER             |
| 13 | BASE LANDING SHOULDER        |
| 14 | STEEL BALL 22.0 mm           |
| 15 | LANDING INDICATOR BUSHING    |
| 16 | LOCK NUT                     |
| 17 | SPINDLE                      |
| 18 | SHUT OFF VALVE (2)           |
| 19 | VALVE ADJUSTING WASHER (2)   |
| 20 | BALL THRUST BEARING          |
| 21 | SPINDLE BEARING              |
| 22 | HANGER BEARING               |
| 23 | COMPRESSION SPRING           |
| 24 | SELF LOCK NUT                |
| 25 | INNER TUBE CAP ASSY          |
| 26 | GREASE FITTING               |
| 27 | STEEL BALL 22.0 mm           |
| 28 | CHECK VALVE BODY             |
| 29 | INNER TUBE 5 FEET / 10 FEET  |
| 30 | STOP RING                    |
| 31 | CORE LIFTER                  |
| 32 | CORE LIFTER CASE             |
| 33 | LOCKING COUPLING             |
| 34 | ADAPTER COUPLING             |
| 35 | LANDING RING                 |
| 36 | OUTER TUBE 5 FEET / 10 FEET  |
| 37 | INNER TUBE STABILIZER        |
| 38 | PROTECTIVE COUPLING          |